



## OPTICAL ACCESSORIES RANGE

ACCESSORIES CONNECTABLE ON BORESCOPES, MICROBORESOPES,  
FIBERSCOPES, MICROFIBERSCOPES, FIBERPROBES  
32 MM DIAMETER STANDARD EYEPIECE  
"MVS" QUICK-LOCK MECHANISM WITH POSSIBILITY OF ROTATION-LOCKING  
THE EYEPIECE  
MULTILAYERED ANTI-REFLECTION COATING OF OPTICAL COMPONENTS  
FULL METAL BODY

LATERAL VIEWING ADAPTOR  
90° optical reflection  
Upright image

OBLIQUE VIEWING ADAPTOR  
60° optical reflection  
Upright image

MAGNIFICATION ADAPTORS  
Variable or fixed magnification of eyepiece image  
Focus adjustment  
Upright image

VOCATION : Industrial Endoscopy



## LATERAL VIEWING ADAPTOR

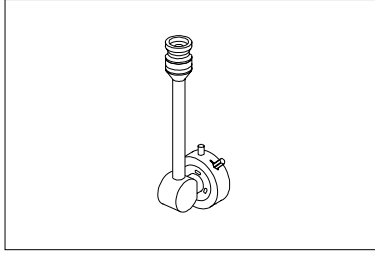

REFERENCE	LENGTH (CM)
VAL 100 SS	11
VAL 250 SS	25
VAL 390 SS	39
VAL 600 SS	55
VAL 680 SS	68
VAL 1000 DS	90 (2 PARTS)

## OBLIQUE VIEWING ADAPTOR

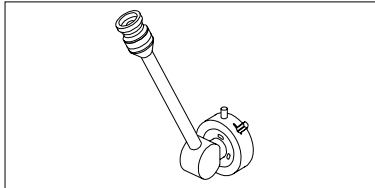

REFERENCE	LENGTH (CM)
VAO 120 SS	11
VAO 300 SS	25
VAO 390 SS	39

## 2 X MAGNIFICATION ADAPTOR

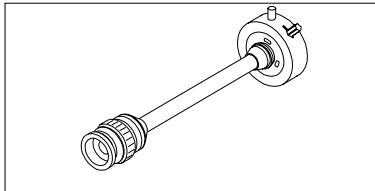

REFERENCE	LENGTH (CM)
GI 200 SS	20

## 1.5 TO 3 X VARIABLE MAGNIFICATION ADAPTOR

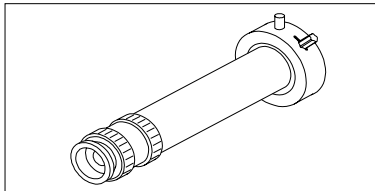

REFERENCE	LENGTH (CM)
GIZ 200 SS	20

## OPTIONS

Adaptors without an MVS can be screwed into EFER's 32 mm standard eyepieces through a canon internal threading Quick-lock mechanism for WOLF standard eyepieces  
WOLF standard eyepieces

EFER reserves the right to modify product specifications without notice

6510 Corporate Drive  
Cincinnati, Ohio, USA 45242  
USA

**Rhinestahl** Corporation

513 489-1317  
fax 513 489-3899  
www.rhinestahl.com

AEROSPACE MANUFACTURING AND ENGINEERED SOLUTIONS SINCE 1967 · ISO 9001:2000 REGISTERED · AS 9000 COMPLIANT